

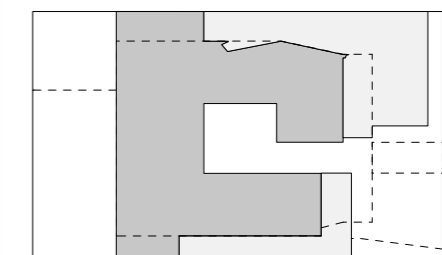

a.-	living area	4.2m x 5.8m
b.-	dining	3.5m x 2.6m
c.-	kitchen	3.2m x 2.6m
d.-	bedroom 2	3.7m x 4.7m
e.-	bathroom	1.8m x 3.7m
f.-	laundry	3.6m x 1.8m
g.-	bedroom 3	3.6m x 5.1m
h.-	study	2.0m x 2.1m
i.-	ensuite (main bedroom)	3.3m x 2.1m
j.-	main bedroom	4.0m x 3.9m

- F.- refrigerator
- L.- washing machine
- S.- storage
- P.- pantry



UNIT 1	
internal size:	154 sqm
front open space size:	61 sqm
balcony:	8 sqm
parking:	1



UNIT 1 - FIRST LEVEL

Scale 1:75 @ A3



- a.- living area 4.2m x 3.1m
- b.- dining 4.1m x 2.7m
- c.- kitchen 3.5m x 2m
- d.- ensuite (main bedroom) 2.9m x 2.9m
- e.- main bedroom 4.1m x 4.7m
- f.- bedroom 2 3.2m x 3.2m
- g.- bathroom 1.7m x 2.1m
- F.- refrigerator
- L.- washing machine
- S.- storage

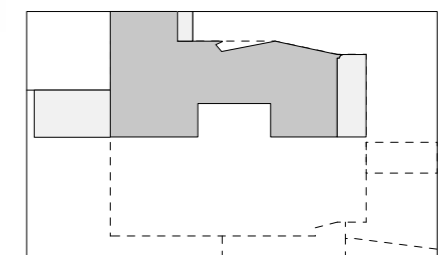

BULGA ROAD

UNIT 2
 internal size: 85 sqm
 courtyard size: 16 sqm
 balcony: 11 sqm
 Parking: 1



UNIT 2 - SECOND LEVEL

Scale 1:75 @ A3



a.-	living area	4.2m x 3.1m
b.-	dining	4.1m x 2.7m
c.-	kitchen	3.0m x 2m
d.-	ensuite (main bedroom)	2.3m x 2.9m
e.-	main bedroom	4.1m x 2.9m
f.-	bedroom 2	3.2m x 3.2m
g.-	bathroom	1.7m x 2.1m

- F.- refrigerator
- L.- washing machine
- S.- storage

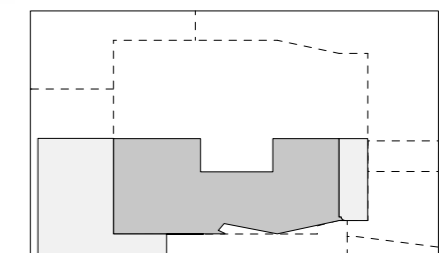

UNIT 3	
internal size:	78 sqm
courtyard size:	39 sqm
balcony size:	11 sqm
Parking:	1



UNIT 3 - SECOND LEVEL

Scale 1:75 @ A3



a.-	living area	4.2m x 3.1m
b.-	dining	4.1m x 2.7m
c.-	kitchen	3.0m x 2m
d.-	ensuite (main bedroom)	2.3m x 2.9m
e.-	main bedroom	4.1m x 2.9m
f.-	bedroom 2	3.2m x 3.2m
g.-	bathroom	1.7m x 2.1m

- F.- refrigerator
- L.- washing machine
- S.- storage

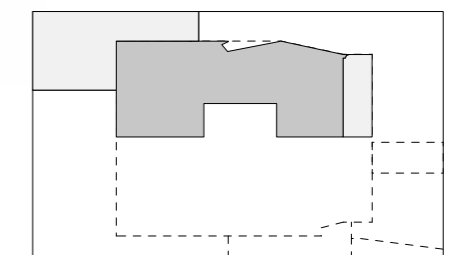

UNIT 4	
internal size:	78 sqm
courtyard size:	32 sqm
balcony size:	11 sqm
Parking:	1



UNIT 4 - THIRD LEVEL

Scale 1:75 @ A3



a.-	living area	4.2m x 3.1m
b.-	dining	4.1m x 2.7m
c.-	kitchen	3.0m x 2m
d.-	ensuite (main bedroom)	2.3m x 2.9m
e.-	main bedroom	4.1m x 2.9m
f.-	bedroom 2	3.2m x 3.2m
g.-	bathroom	1.7m x 2.1m

- F.- refrigerator
- L.- washing machine
- S.- storage

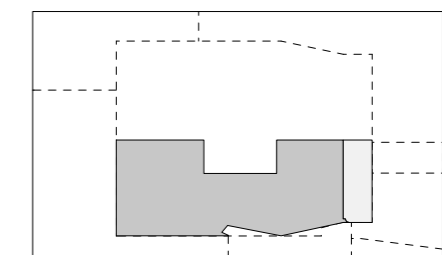

BULGA ROAD

UNIT 5
 internal size: 78 sqm
 balcony size: 11 sqm
 Parking: 1





a.-	living area	5.7m x 3.7m
b.-	dining	4.6m x 3.2m
c.-	kitchen	4.3m x 2.8m
d.-	bedroom 2	3.4m x 2.9m
e.-	bedroom 3	3.6m x 2.9m
f.-	bathroom	1.6m x 2.6m
g.-	robe (main bedroom)	1.6m x 2.7m
h.-	ensuite (main bedroom)	1.6m x 3.4m
i.-	main bedroom	4.4m x 3.4m

- F.- refrigerator
- L.- washing machine

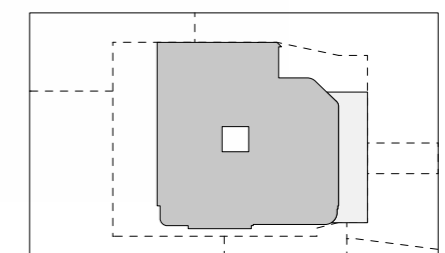

BULGA ROAD

UNIT 6	
internal size:	123 sqm
balcony size:	18 sqm
Parking:	2

